

ANSI STANDARD ROLLER CHAIN

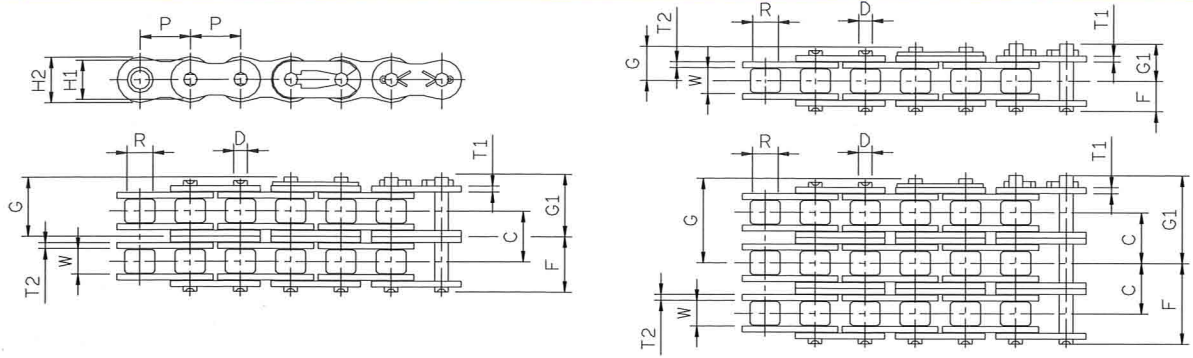

CHAIN NO.	Pitch		Width	Roller	Plate				Pin				Transverse Pitch	Average Ultimate Strength	Approx Weight
	P		W		Height		Thickness		Lengths						
	inch	mm	mm	R	H1	H2	T1	T2	D	F	G	G1	C	kgf	kg/m
* 25-1	1/4"	6.35	3.18	3.30	5.00	5.80	0.75	0.75	2.30	3.80	4.80	---	---	450	0.14
* 25-2	1/4"	6.35	3.18	3.30	5.00	5.80	0.75	0.75	2.30	7.03	8.02	---	6.40	900	0.26
* 25-3	1/4"	6.35	3.18	3.30	5.00	5.80	0.75	0.75	2.30	10.20	11.20	---	6.40	1350	0.40
* 35-1	3/8"	9.525	4.76	5.08	7.60	9.00	1.20	1.20	3.59	5.80	7.00	7.60	---	1050	0.33
* 35-2	3/8"	9.525	4.76	5.08	7.60	9.00	1.20	1.20	3.59	10.80	12.00	12.70	10.10	2100	0.69
* 35-3	3/8"	9.525	4.76	5.08	7.60	9.00	1.20	1.20	3.59	15.90	17.10	17.40	10.10	3150	1.05
41	1/2"	12.70	6.35	7.77	8.50	9.70	1.20	1.20	3.58	6.60	7.95	8.50	---	1200	0.41
40-1	1/2"	12.70	7.94	7.92	10.20	11.80	1.50	1.50	3.96	8.20	9.35	10.10	---	1850	0.63
40-2	1/2"	12.70	7.94	7.92	10.20	11.80	1.50	1.50	3.96	15.30	17.00	17.60	14.40	3700	1.19
40-3	1/2"	12.70	7.94	7.92	10.20	11.80	1.50	1.50	3.96	22.65	23.80	24.55	14.40	5550	1.77
50-1	5/8"	15.875	9.53	10.16	13.00	14.80	2.00	2.00	5.06	10.10	11.65	12.60	---	3100	1.01
50-2	5/8"	15.875	9.53	10.16	13.00	14.80	2.00	2.00	5.06	19.20	20.70	21.10	18.10	6200	2.04
50-3	5/8"	15.875	9.53	10.16	13.00	14.80	2.00	2.00	5.06	28.30	29.65	30.20	18.10	9300	3.05
60-1	3/4"	19.05	12.70	11.91	15.50	17.50	2.40	2.40	5.95	12.50	14.15	15.40	---	4400	1.44
60-2	3/4"	19.05	12.70	11.91	15.50	17.50	2.40	2.40	5.95	24.00	25.50	26.90	22.80	8800	3.03
60-3	3/4"	19.05	12.70	11.91	15.50	17.50	2.40	2.40	5.95	35.35	36.95	37.65	22.80	13200	4.50
80-1	1"	25.40	15.88	15.88	20.40	24.00	3.10	3.10	7.94	16.10	17.75	18.80	---	7800	2.40
80-2	1"	25.40	15.88	15.88	20.40	24.00	3.10	3.10	7.94	30.60	32.20	33.60	29.30	15600	5.26
80-3	1"	25.40	15.88	15.88	20.40	24.00	3.10	3.10	7.94	45.30	47.00	48.00	29.30	23400	7.80
100-1	1-1/4"	31.75	19.05	19.05	24.80	30.10	3.90	3.90	9.52	20.10	---	23.10	---	11800	3.74
100-2	1-1/4"	31.75	19.05	19.05	24.80	30.10	3.90	3.90	9.52	38.00	---	41.00	35.80	23600	7.51
100-3	1-1/4"	31.75	19.05	19.05	24.80	30.10	3.90	3.90	9.52	55.90	---	58.90	35.80	35400	11.20
120-1	1-1/2"	38.10	25.40	22.23	30.00	35.00	4.70	4.70	11.10	25.20	---	28.60	---	15500	6.18
120-2	1-1/2"	38.10	25.40	22.23	30.00	35.00	4.70	4.70	11.10	47.90	---	51.30	45.40	31000	12.25
120-3	1-1/2"	38.10	25.40	22.23	30.00	35.00	4.70	4.70	11.10	70.60	---	74.00	45.40	46500	18.30
140-1	1-3/4"	44.45	25.40	25.40	36.20	42.00	5.60	5.60	12.70	27.30	---	31.50	---	21500	7.49
140-2	1-3/4"	44.45	25.40	25.40	36.20	42.00	5.60	5.60	12.70	51.75	---	55.75	48.90	43000	14.83
140-3	1-3/4"	44.45	25.40	25.40	36.20	42.00	5.60	5.60	12.70	76.20	---	80.40	48.90	64500	22.20
160-1	2"	50.80	31.75	28.58	41.40	48.00	6.40	6.40	14.28	32.55	---	37.25	---	27500	10.10
160-2	2"	50.80	31.75	28.58	41.40	48.00	6.40	6.40	14.28	61.80	---	66.50	58.50	55000	20.04
160-3	2"	50.80	31.75	28.58	41.40	48.00	6.40	6.40	14.28	91.05	---	95.75	58.50	82500	30.02
180-1	2-1/4"	57.15	35.71	35.71	46.70	54.20	7.20	7.20	17.45	36.50	---	42.20	---	36000	13.40
180-2	2-1/4"	57.15	35.71	35.71	46.70	54.20	7.20	7.20	17.45	69.42	---	75.12	65.84	72000	26.20
180-3	2-1/4"	57.15	35.71	35.71	46.70	54.20	7.20	7.20	17.45	102.34	---	108.04	65.84	108000	38.10
200-1	2-1/2"	63.50	38.10	39.68	51.80	60.10	8.00	8.00	19.84	39.75	---	47.10	---	46000	16.50
200-2	2-1/2"	63.50	38.10	39.68	51.80	60.10	8.00	8.00	19.84	75.55	---	82.85	71.60	92000	32.70
200-3	2-1/2"	63.50	38.10	39.68	51.80	60.10	8.00	8.00	19.84	111.35	---	118.65	71.60	138000	49.05
240-1	3"	76.20	47.63	47.60	62.20	72.10	9.50	9.50	23.80	47.70	---	54.80	---	68500	24.20
240-2	3"	76.20	47.63	47.60	62.20	72.10	9.50	9.50	23.80	91.60	---	98.70	87.80	137000	47.80
240-3	3"	76.20	47.63	47.60	62.20	72.10	9.50	9.50	23.80	135.50	---	142.60	87.80	205500	71.10

* Rollerless chain, R indicates bushing diameter.

STAINLESS STEEL CHAIN

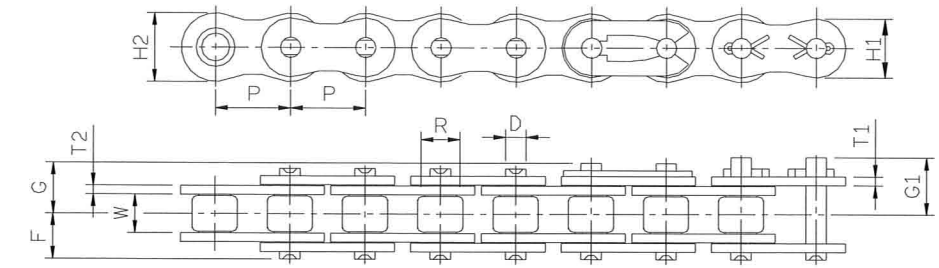

F TYPE

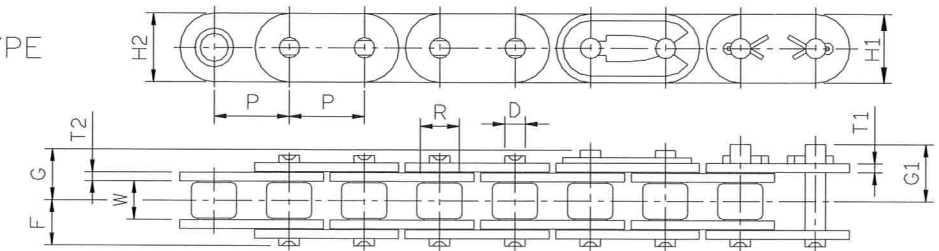

CHAIN NO.	Pitch		Width	Roller	Plate				Pin				Max Allowable Load	Approx Weight
	P		W		Height		Thickness		Lengths					
	inch	mm	mm	R	H1	H2	T1	T2	D	F	G	G1	kgf	kg/m
* 25SS	1/4"	6.35	3.18	3.30	5.00	5.80	0.75	0.75	2.30	3.80	4.80	---	12	0.14
* 35SS	3/8"	9.525	4.76	5.08	7.60	9.00	1.20	1.20	3.59	5.80	7.00	7.60	27	0.33
40SS	1/2"	12.70	7.94	7.92	10.20	11.80	1.50	1.50	3.96	8.20	9.35	10.10	45	0.63
50SS	5/8"	15.875	9.53	10.16	13.00	14.60	2.00	2.00	5.06	10.10	11.65	12.60	70	1.01
60SS	3/4"	19.05	12.70	11.91	15.50	17.50	2.40	2.40	5.95	12.50	14.15	15.40	105	1.44
80SS	1"	25.40	15.88	15.88	20.40	24.00	3.10	3.10	7.94	16.10	17.75	18.80	180	2.52
100SS	1-1/4"	31.75	19.05	19.05	24.80	30.10	3.90	3.90	9.52	20.10	---	23.10	260	3.74
120SS	1-1/2"	38.10	25.40	22.23	30.00	35.00	4.70	4.70	11.10	25.20	---	28.60	390	6.08
C2040SS	1"	25.40	7.94	7.92	11.70	11.70	1.50	1.50	3.96	8.20	9.35	10.10	45	0.50
C2042SS	1"	25.40	7.94	15.88	11.70	11.70	1.50	1.50	3.96	8.20	9.35	10.10	45	1.20
A2040SS	1"	25.40	7.94	7.92	10.10	11.70	1.50	1.50	3.96	8.20	9.35	10.10	45	0.40
C2050SS	1-1/4"	31.75	9.53	10.16	14.60	14.60	2.00	2.00	5.06	10.10	11.65	12.60	70	0.84
C2052SS	1-1/4"	31.75	9.53	19.05	14.60	14.60	2.00	2.00	5.06	10.10	11.65	12.60	70	1.26
A2050SS	1-1/4"	31.75	9.53	10.16	12.60	14.60	2.00	2.00	5.06	10.10	11.65	12.60	70	0.66
C2060SS	1-1/2"	38.10	12.70	11.91	17.10	17.10	2.40	2.40	5.95	12.50	14.15	15.40	105	1.10
C2060HSS	1-1/2"	38.10	12.70	11.91	17.10	17.10	3.10	3.10	5.95	14.10	15.70	16.60	105	1.37
C2062HSS	1-1/2"	38.10	12.70	22.23	17.10	17.10	3.10	3.10	5.95	14.10	15.70	16.60	105	2.05
C2080HSS	2"	50.80	15.88	15.88	23.00	23.00	3.90	3.90	7.94	17.90	19.40	20.80	180	2.41
C2082HSS	2"	50.80	15.88	28.58	23.00	23.00	3.90	3.90	7.94	17.90	19.40	20.80	180	3.37
06BSS	0.375"	9.525	5.72	6.35	8.10	8.10	1.00	1.25	3.24	6.10	7.40	---	27	0.39
08BSS	0.5"	12.70	7.75	8.51	10.20	11.80	1.50	1.50	4.44	8.20	9.50	---	50	0.65
10BSS	0.625"	15.875	9.65	10.16	13.00	14.60	1.65	1.65	5.04	9.60	11.10	---	66	0.92
12BSS	0.75"	19.05	11.68	12.07	16.00	16.00	1.80	1.80	5.65	11.10	12.60	---	90	1.24
16BSS	1"	25.40	17.02	15.88	20.80	20.80	3.20	4.00	8.24	17.70	19.25	20.20	209	2.65
40FSS	1/2"	12.70	7.94	7.92	11.80	11.80	1.50	1.50	3.96	8.20	9.35	10.10	45	0.65
50FSS	5/8"	15.875	9.53	10.16	15.00	15.00	2.00	2.00	5.06	10.10	11.65	12.60	70	1.03
60FSS	3/4"	19.05	12.70	11.91	18.10	18.10	2.40	2.40	5.95	12.50	14.15	15.40	105	1.46

* Rollerless chain, R indicates bushing diameter.